



# **NEXUS WHIZZER & MOMENTUM BEARING UPGRADE**

NO PART OF THIS MANUAL OR DOCUMENT MAY BE COPIED OR RE-PRODUCED IN ANY FORM OR BY ANY MEANS WITH OUT THE EXPRESS WRITTEN PERMISSION OF SMP (PLAYGROUNDS) LTD.

email: [sales@smp.co.uk](mailto:sales@smp.co.uk)  
[www.smp.co.uk](http://www.smp.co.uk)

## NEXUS WHIZZER & MOMENTUM BEARING UPGRADE

The assembly described below is for the Upgraded Bearing Assembly. This will be supplied complete by SMP.

ASSEMBLED COMPONENTS				
ITEM	CODE	DESCRIPTION	QTY.	WEIGHT (kg)
1	38004001	BEARING ASSEMBLY	1	11.000
2	71000109	HOLDING WASHER	1	0.080
3	10121030	RESISTORX HEAD M10 x 30	1	0.030
4	10309999	HEAVY DUTY WASHER M10	2	0.011
5	10121000	M10 TORX TOOL	1	-

### 1 OLD BEARING ASSEMBLY REMOVAL

- i) Dis-assemble the Old Bearing Assembly by removing the M6 x 20 Resistorx bolts and Washers holding the existing Poly Upper Cover in place.
- ii) Dis-assemble the Old Bearing Assembly by removing the M10 x 30 Resistorx bolt in the centre of the Shaft & Base Fabrication and remove the Holding Washer.
- iii) Slide the Old Bearing Assembly off the Shaft & Base Fabrication and discard.
- iv) Remove all debris from shaft and clean as necessary.

### 2 BEARING ASSEMBLY REPLACEMENT

- v) If the existing shaft is showing signs of wear apply a suitable Bearing Fit Adhesive (Loctite 641), not supplied, to the mounting diameters on the Shaft for the two bearings.
- vi) Slide the Bearing Assembly (item 1) over the Shaft. (FIG.1).

**NOTE: Ensure that the Bearing Assembly is fully pressed home.**

- vii) Secure the Bearing Assembly in place with the Holding Washer (item 2), Heavy Duty Washers (item 4) and a Resistorx M10 x 30 bolt (item 3). Fully tighten to 20-25 Nm. (FIG.1).

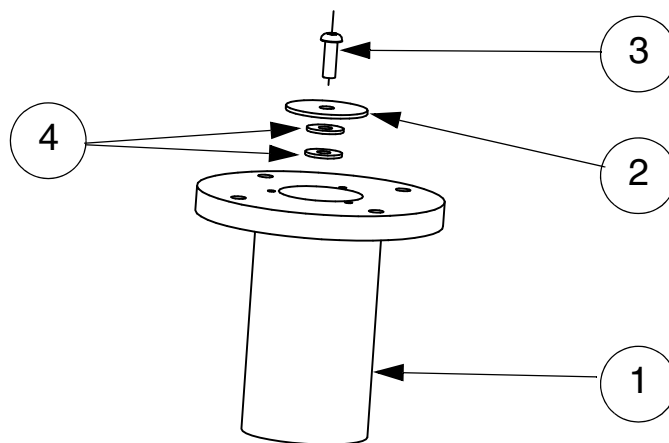

APPLY BEARING FIT ADHESIVE TO THESE TWO FACES IF REQUIRED

EXISTING SHAFT & BASE FABRICATION

**FIG.1**